

MCX EDGE MOUNT PCB PLUG

45-411-D3-1,6

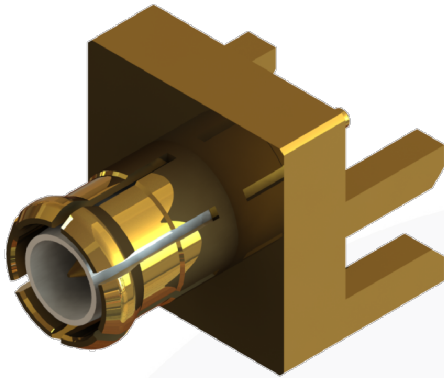

images for illustration purposes only

Environmental Specification

Operating Temp: -55 to +155 Deg C.

IP Rating (Mated): IP 40

Electrical Specification

Impedance: 50 Ohm

Frequency: 0-6 GHz

Dielectric W/V: 500 Veff

Insulation res: 1000 M-Ohm

Mechanical Specification

Contact Retention: 15 N min

Cable Retention: N/A N min

Mating cycles: 500

Weight: 0.82 g

Connector Interface

image for illustration purposes only

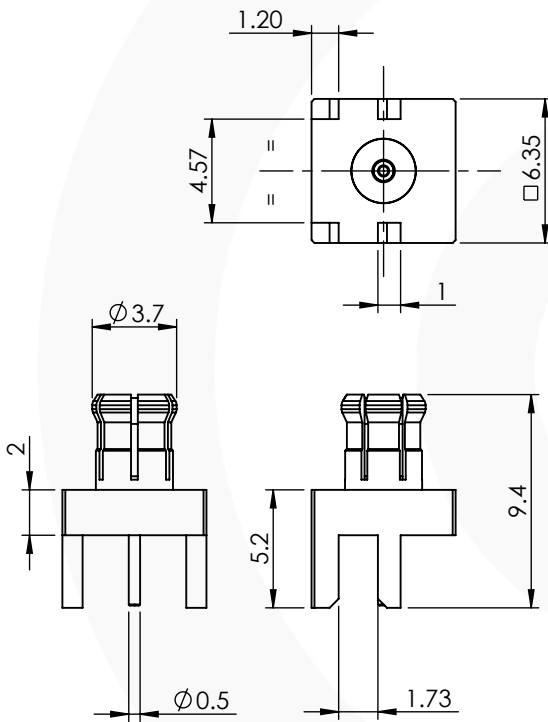
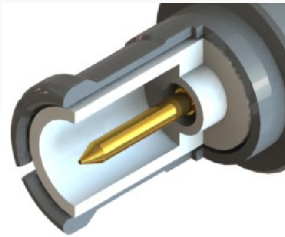

4	INSULATOR	PTFE	N/A
3	OUTER CONTACT	PHOSPHOR BRONZE	GOLD
2	CENTRE CONTACT	BRASS	GOLD
1	BODY	BRASS	GOLD
ITEM	DESCRIPTION	MATERIAL	PLATING

A4	SHEET 1 OF 1	DIMENSIONS ARE IN MILLIMETRES		
REVISION :	A00	NAME	SIGNATURE	DATE
ISSUE :	1	DRAWN	G.E.	06/04/2022
		CHK'D	P.S.	06/04/2022
		APPV'D		
6-8 COLNE ROAD, TWICKENHAM, MIDDLESEX. TW1 4JR				
<small>THE INFORMATION IS GIVEN AS AN INDICATION ONLY AND IS SUBJECT TO CHANGE WITHOUT NOTICE. IN THE CONTINUAL GOAL TO IMPROVE OUR PRODUCTS, WE RESERVE THE RIGHT TO MAKE ANY MODIFICATIONS NECESSARY WITHOUT PRIOR NOTICE.</small>				