

SMA RP RIGHT ANGLED SOLDER/CRIMP PLUG

31-105-1-J3-AD

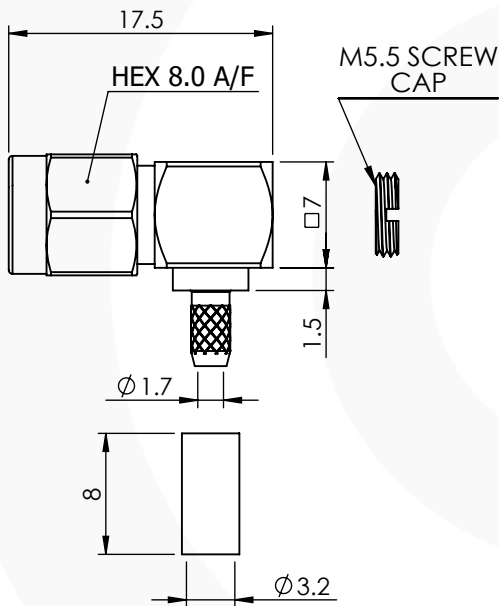

images for illustration purposes only



Suitable for Cables:

(AD) RG316, RG174, RG188, LMR100, WBC100, URM95, KX3, KX22

Stripping Dimensions

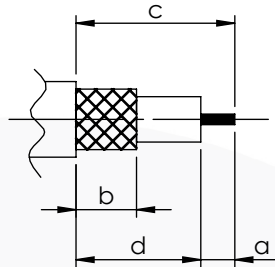

a = 2.0 mm
b = 6.0 mm
c = 12.0 mm
d = 10.0 mm

Assembly Procedure:

Tooling

Centre Contact: Solder Tool No: Not Applicable
Crimp Sleeve: Hex 3.25mm A/F Tool No: 336J

Alignment Tool: Not Applicable Extraction: Not Applicable

Environmental Specification

Operating Temp: -55 to +155 Deg C.
IP Rating (Mated): IP 54

Electrical Specification

Impedance: 50 Ohm
Frequency: 0 - 12 GHz
Dielectric W/V: 750 Veff
Insulation res: 5000 M-Ohm

Mechanical Specification

Contact Retention: 27 N min
Cable Retention: 90 N min
Mating cycles: 100
Weight: 5.53 g

Connector Interface

image for illustration purposes only

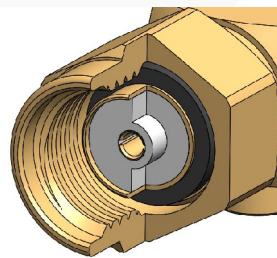

6	SCREW CAP	BRASS	BLACK
5	COUPLING NUT	BRASS	BLACK NICKEL
4	GASKET	SILICONE	N/A
3	INSULATOR	PTFE	N/A
2	CENTRE CONTACT	BeCu	GOLD
1	BODY	BRASS	BLACK NICKEL
ITEM	DESCRIPTION	MATERIAL	PLATING

A4	SHEET 1 OF 1	DIMENSIONS ARE IN MILLIMETRES		
REVISION :	C00	NAME	SIGNATURE	DATE
ISSUE :	1	DRAWN	G.E.	09/11/2021
		CHK'D	P.S.	09/11/2021
		APPV'D		
6-8 COLNE ROAD, TWICKENHAM, MIDDLESEX. TW1 4JR				
<small>THE INFORMATION IS GIVEN AS AN INDICATION ONLY AND IS SUBJECT TO CHANGE WITHOUT NOTICE. IN THE CONTINUAL GOAL TO IMPROVE OUR PRODUCTS, WE RESERVE THE RIGHT TO MAKE ANY MODIFICATIONS NECESSARY WITHOUT PRIOR NOTICE.</small>				