

BT43 STRAIGHT CRIMP/CRIMP SOCKET 4FS

43-060-D6-AB

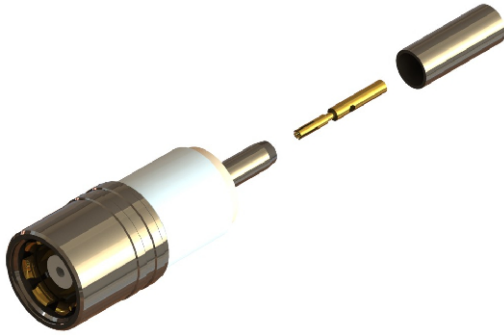

images for illustration purposes only

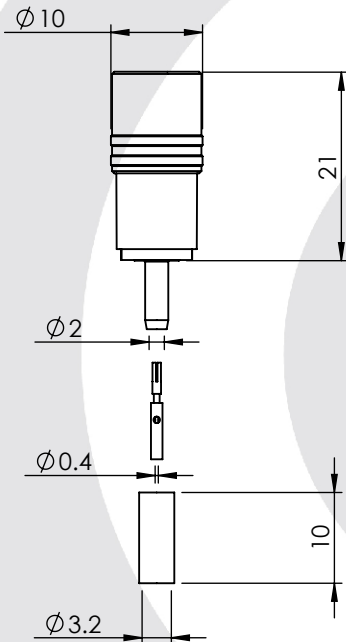

Suitable for Cables:

(AB) RG179, RG187, Belden 179DT

Stripping Dimensions

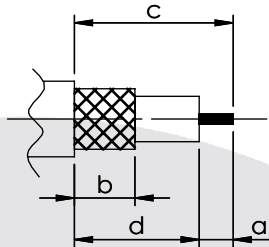

a = 4.5 mm
b = 8.0 mm
c = 21.0 mm
d = 16.5 mm

* CUT FOIL TO DIM. "b"

Assembly Procedure: AP023

Tooling

Centre Contact: Square Crimp Tool No: HTS-43

Crimp Sleeve: HEX 3.25mm A/F Tool No: HTS-43

Alignment Tool: Not Applicable Extraction: Not Applicable

Environmental Specification

Operating Temp: -40 to +100 Deg C

IP Rating (Mated): NONE

Electrical Specification

Impedance: 75 Ohm

Frequency: 0 - 3 GHz

Dielectric W/V: 1500 Veff

Insulation res: 5000 M-Ohm

Mechanical Specification

Contact Retention: 22 N min

Cable Retention: 60 N min

Mating cycles: 250

Weight: 6.19 g

Connector Interface

image for illustration purposes only

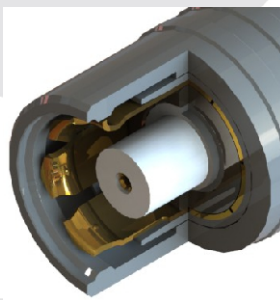

7	SLEEVE / SPRING	NYLON	N/A
6	OUTER CONTACT	PHOSPHOR BRONZE	GOLD
5	LATCHING SLEEVE	BRASS	NICKEL
4	CRIMP SLEEVE	BRASS	NICKEL
3	INSULATOR	PTFE	N/A
2	CENTRE CONTACT	BERYLLIUM COPPER	GOLD
1	BODY	BRASS	NICKEL
ITEM	DESCRIPTION	MATERIAL	PLATING

A4	SHEET 1 OF 1	DIMENSIONS ARE IN MILLIMETRES				
REVISION :	A04		NAME	SIGNATURE	DATE	
DRAWN	GE				04/04/2007	
ISSUE :	2		CHK'D	IG		17/12/2007
			APPV'D			
<p>6-8 COLNE ROAD, TWICKENHAM, MIDDLESEX. TW1 4JR</p> <p>THE INFORMATION IS GIVEN AS AN INDICATION ONLY AND IS SUBJECT TO CHANGE WITHOUT NOTICE. IN THE CONTINUAL GOAL TO IMPROVE OUR PRODUCTS, WE RESERVE THE RIGHT TO MAKE ANY MODIFICATIONS NECESSARY WITHOUT PRIOR NOTICE.</p>						