

SMB STRAIGHT CRIMP/CRIMP JACK 32-054-B3-AD

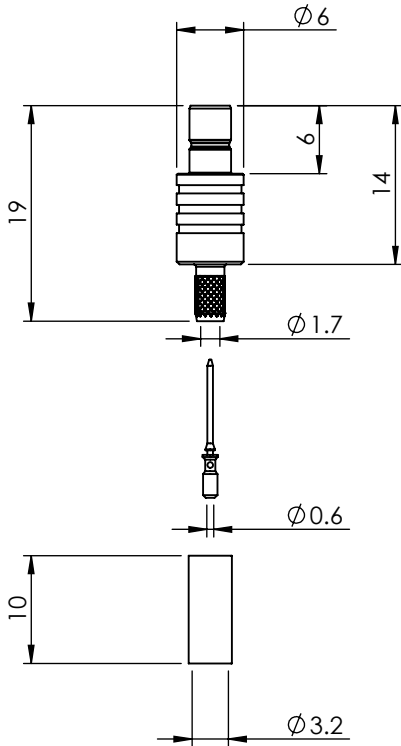

images for illustration purposes only



Suitable for Cables:

(AD) RG316, RG174, RG188, LMR100, WBC100, URM95, KX3, KX22

Stripping Dimensions

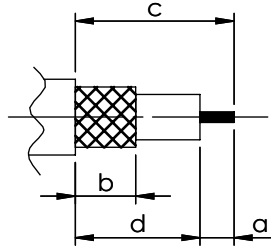

a = 3.0 mm
b = 5.0 mm
c = 9.0 mm
d = 6.0 mm

* CUT FOIL TO DIM. "b"

Assembly Procedure: AP023I

Tooling

Centre Contact: SQ 0.85mm A/F Tool No: HTS-43

Crimp Sleeve: Hex 3.25mm A/F Tool No: HTS-43

Environmental Specification

Operating Temp: -55 to +155 Deg C.

IP Rating (Mated):

Electrical Specification

Impedance: 50 Ohm

Frequency: 0-4.5 GHz

Dielectric W/V: 1000 Veff

Insulation res: 5000 M-Ohm

Mechanical Specification

Contact Retention: 10 N min

Cable Retention: 50 N min

Mating cycles: 250

Weight: 2.06 g

Connector Interface

image for illustration purposes only

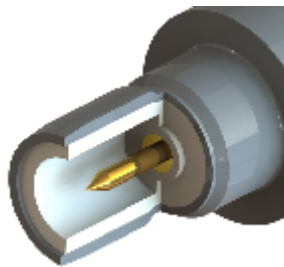

| 4 | CRIMP SLEEVE | BRASS | NICKEL |
|------|----------------|------------------|---------|
| 3 | INSULATOR | PTFE | N/A |
| 2 | CENTRE CONTACT | BERYLLIUM COPPER | GOLD |
| 1 | BODY | BRASS | NICKEL |
| ITEM | DESCRIPTION | MATERIAL | PLATING |

| | | | | | |
|--|--------------|-------------------------------|-------|-----------|------------|
| A4 | SHEET 1 OF 1 | DIMENSIONS ARE IN MILLIMETRES | | | |
| REVISION : | 000 | | NAME | SIGNATURE | DATE |
| DRAWN : | 2 | | GE | | 19/06/2013 |
| ISSUE : | | | CHK'D | IG | |
| 6-8 COLNE ROAD, TWICKENHAM, MIDDLESEX. TW1 4JR | | APPV'D | | | |
| <small>THE INFORMATION IS GIVEN AS AN INDICATION ONLY AND IS SUBJECT TO CHANGE WITHOUT NOTICE. IN THE CONTINUAL GOAL TO IMPROVE OUR PRODUCTS, WE RESERVE THE RIGHT TO MAKE ANY MODIFICATIONS NECESSARY WITHOUT PRIOR NOTICE.</small> | | | | | |