

Assembly Procedure

- Slide crimp sleeve onto cable
- Strip cable & add a 0.5mm x 45° Chamfer to the end of the centre conductor.

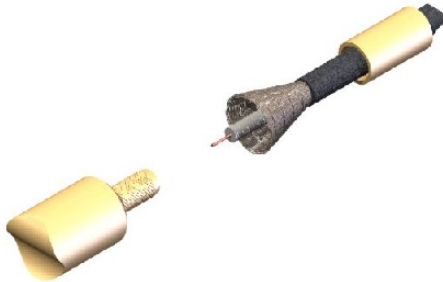

- Fan the braid out
- Slide the cable into the connector and push home until the centre contact is in place.



- Slide the crimp sleeve over the braid
- Crimp the crimp sleeve using the appropriate sized crimp tool (trim excess braid if necessary)

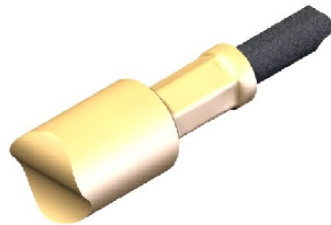

Electrical Specification

Impedance: 50 Ohm
 Frequency: 0 - 12.8 Ghz (Cable Limited)
 Dielectric W/V: 750 V
 Insulation res: 1000 M-Ohm

Mechanical Specification

Centre contact retention
 Axial Force:
 Cable Retention: 200N min
 Mating cycles: 500

Environmental Specification

Operating Temp:

Tooling

Centre Contact: N/A
 Crimp Sleeve: HEX 10.9mm A/F



DO NOT SCALE DRAWING

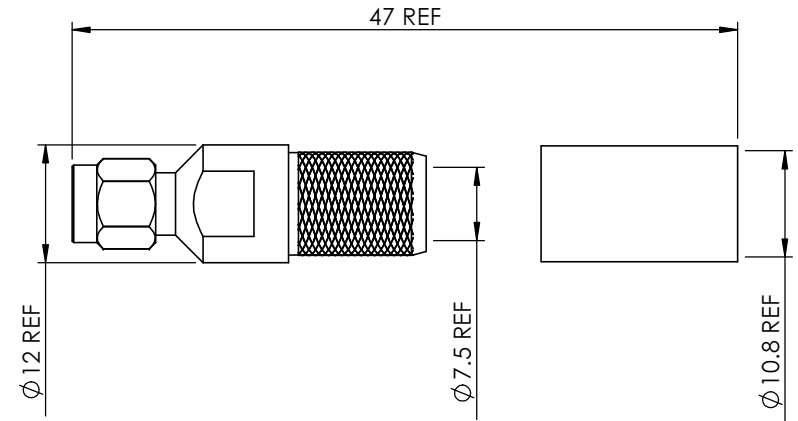

STRIPPING DIMENSIONS

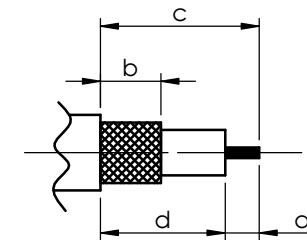

a = 4.0mm
 b = 12.0mm * INCLUDING FOIL
 c = 22.0mm
 d = 18.0mm



COAX CONNECTORS LTD
 6-8 COLNE ROAD, TWICKENHAM,
 MIDDLESEX. TW1 4JR

Description SMA PLUG LMR400

Part Number 30-018-B3-DE

REVISION
 B00

DIMENSIONS ARE IN MILLIMETERS			
A4	NAME	SIGNATURE	DATE
DRAWN	GE		21/10/2009
CHK'D	WF		21/10/2009
APPV'D			

THE INFORMATION IS GIVEN AS AN INDICATION ONLY AND IS SUBJECT TO CHANGE WITHOUT NOTICE. IN THE CONTINUAL GOAL TO IMPROVE OUR PRODUCTS, WE RESERVE THE RIGHT TO MAKE ANY MODIFICATIONS NECESSARY WITHOUT PRIOR NOTICE.

7			
6			
5			
4			
3	CENTRE CONTACT	BRASS	GOLD
2	INSULATOR	PTFE	N/A
1	BODY	BRASS	NICKEL
ITEM	DESCRIPTION	MATERIAL	PLATING